

! RISK OF FIRE AND ELECTRICAL SHOCK. FIXTURE MUST BE INSTALLED BY A QUALIFIED ELECTRICIAN ONLY IN ACCORDANCE WITH NATIONAL, LOCAL BUILDING AND ELECTRICAL CODES. DISCONNECT POWER AT ELECTRICAL PANEL BEFORE SERVICING.

The product styles you received

First style: finished product with power cord

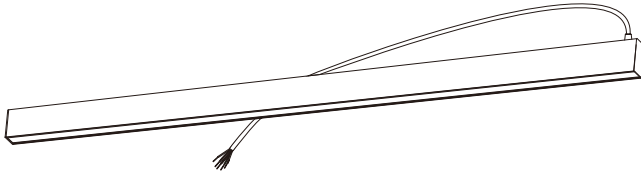

Second style: finished product with separate power cord



① Finished product without power cord

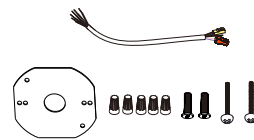

② Power cord kits

Third style: semi-finished product



① Housing



② Down LED module



③ End caps

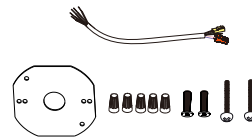

④ Power cord kits

1.3" WALL MOUNT LED

Architectural LED Luminaire Independent Installation

⚠️ RISK OF FIRE AND ELECTRICAL SHOCK. FIXTURE MUST BE INSTALLED BY A QUALIFIED ELECTRICIAN ONLY IN ACCORDANCE WITH NATIONAL, LOCAL BUILDING AND ELECTRICAL CODES. DISCONNECT POWER AT ELECTRICAL PANEL BEFORE SERVICING.

IMPORTANT

1. Read all instructions.
2. Install in accordance with national and local electrical code regulations.
3. This product is intended to be installed and serviced by a qualified, licensed electrician.
4. Do not install in wet locations. For dry and damp use only.
5. Turn off electrical power before installing or servicing fixture in any way.
6. To reduce the risk of fire and overheating, make sure all connections are tight.
7. Under no circumstances can the lighting fixture be covered with heat insulation gasket or similar materials.
8. The maximum connection of each input line is 40FT(1200CM) in 120AC, 80FT(2400CM) in 230AC, 100FT(3000CM) in 277AC.

ACCESSORY

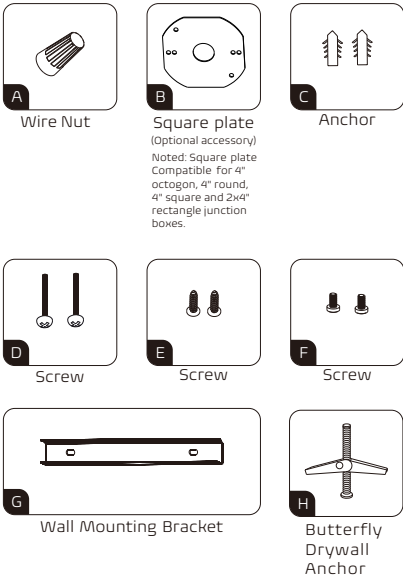

WIRING

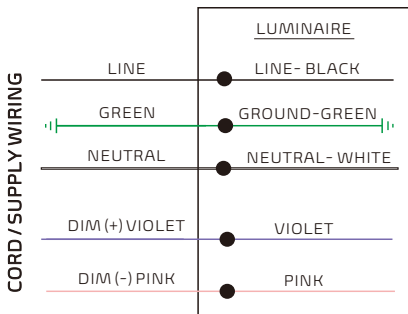

⚠️ Please isolate two dimming wires by P2 terminal individually if no need dimming; **MUST connect wires with corresponding colors as shown.**

INDEPENDENT INSTALLATION

1 Assemble Power Cord

Wiring
Must connect connectors with corresponding colors as shown.

Take off the end cap and LED modular, thread the power cord out of the housing as shown. Wiring and then remount LED modular and end cap.

2 Install mounting point on wall

Holes Size: 1/5"

17/20"

Recommended Distance:
1/4' for 2' fixture,
67/87' for 3' fixture,
1 3/10' for 4' fixture,
3 23/59' for 8' fixture

3 Install plate and bracket

Holes Size: 0.2"

The oval hole can adjust the mounting position and align the power cable with the center of the junction box.

Holes Size: 0.47"

3-1: Insert Anchor "C" into hole and fix the wall mounting bracket "G" with screw "E".
Remark: You can also fix the wall mounting bracket "G" with butterfly drywall anchor "H".

3-2: Mount the square cover plate "B" onto J-box with screw "D", then plastering.

4 Wiring

4-1: Using the wire nut "A" to connect AC wires and dimming wires.

4-2: Hide all wires into the junction box.

5 Mounting

Match the hole position of the fixture and "wall mounting bracket", and mount the fixture onto wall with screw "F".

6 Complete

1.3" WALL MOUNT LED

Architectural LED Luminaire Multiple Luminaires Connection

⚠ RISK OF FIRE AND ELECTRICAL SHOCK. FIXTURE MUST BE INSTALLED BY A QUALIFIED ELECTRICIAN ONLY IN ACCORDANCE WITH NATIONAL, LOCAL BUILDING AND ELECTRICAL CODES. DISCONNECT POWER AT ELECTRICAL PANEL BEFORE SERVICING.

ACCESSORY



"—" Joiner



Silicone Seal

Noted: Silicone Seal is used to seal seams that may appear at both ends of luminaires when multiple connections.

BEFORE CONNECTING

Disassemble luminaires



Start of run (SoR): Remove the end cap without power code, insert the joiner and fix it with screw.



Middle of run (MoR): Remove both end caps, insert the joiner and fix it with screw.



End of run (EoR): Remove the end cap with power code, insert the joiner and fix it with screw.

MULTIPLE LUMINAIRES CONNECTION

1 Install mounting point on wall

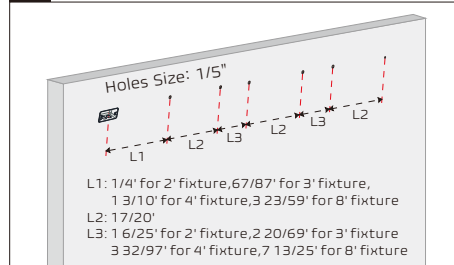

2 Install plate and bracket from SoR to EoR

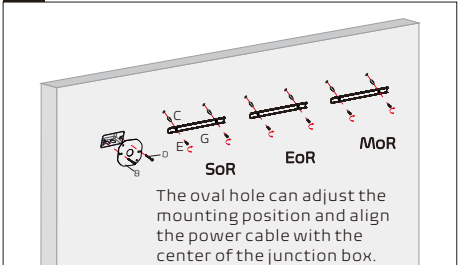

3 Wiring – SoR

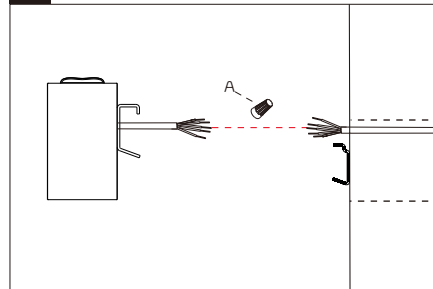

3-1: Using the wire nut "A" to connect AC wires and dimming wires.
3-2: Hide all wires into the junction box.

4 Mounting

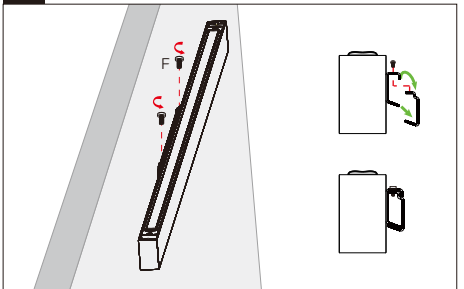

Match the hole position of the fixture and "wall mounting bracket", and mount the fixture onto wall with screw "F".

5 Repeat install and join steps - MoR to EoR

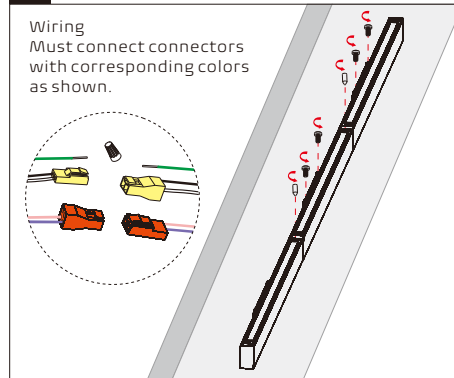

6 Complete

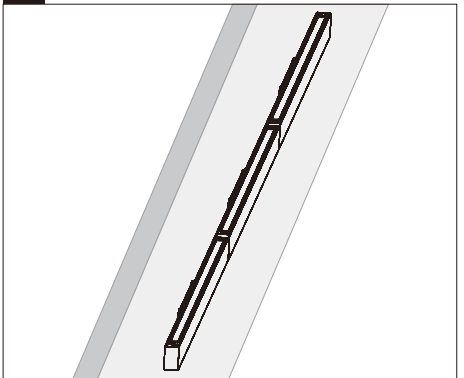

Optional 40' Diffuser Lens Roll

